

Haymes Paint Facilities Maintenance & Strata Solutions



Australia's first family of paint.



SINCE 1935

Facilities maintenance and strata management present diverse, multifaceted challenges that require tailored solutions.

Haymes Paint understands the balance between functionality and aesthetics, preserving heritage charm while fulfilling modern maintenance needs.

Maintenance ranges from touch-ups to refurbishments, all aimed to safeguard property value. We offer an extensive range of high-quality products designed for diverse strata and maintenance projects, offering durable solutions that can withstand heavy use and environmental exposure, while maintaining aesthetic appeal.

Colour plays a pivotal role in enhancing the visual appeal of properties and our wide range of colours are suitable for both interiors and exteriors. Deciding to make a colour change can be challenging, our colour consultation service provides valuable assistance in ensuring a great outcome.

Our facility maintenance support extends to various sectors, including:

- + Body corporate strata sites
- + Shopping centres
- + Education facilities
- + Healthcare institutions
- + Correctional facilities
- + Heritage buildings
- + Leisure and entertainment resorts
- + Gymnasiums & sporting facilities
- + Factories
- + Retail and hospitality venues

Front Cover: Glen Waverley Anglican Church

This Page:

Top Imagery: Kingswood College

Bottom Imagery: Glen Waverley Anglican Church

Product: Ultra Premium Solashield® Exterior

Colour: Haymes Paint custom colour match



Product: Ultra Premium Solashield® Exterior

Colour: Haymes Paint 'Oak Buff 2'



Product: Ultra Premium Expressions® Interior

Colour: Haymes Paint 'Nearly White 2'



The story of Australia's first family of paint.

Born in Ballarat in 1935, our business is the result of Henry Haymes' passion for providing quality, innovative paint and coating products to Australians. The business has been passed down through generations, with each Haymes family member contributing to our long-standing history of providing quality products.

We ensure our customers always have the best products to choose from; we're constantly innovating and utilising new technology.

"After all, it is our name and reputation on the can."



From left to right: Belinda Haymes, Rod Walton, Jenny Haymes, Matt Haymes and Tim Haymes.



We remain committed to supporting other family-owned businesses – whether that's local Paint Specialists, a hardware store that stocks our paint, or the professional trade painting contractors who use Haymes Paint every day.

Haymes Paint has evolved into the largest family-owned paint manufacturer in Australia. We have a dedicated team working across our network, and our products can be found at over 350 locations nationwide in a wide range of stockists, including Haymes Paint Shops and PaintRight stores. Today, our business is led by the third generation of the Haymes family.

We are still Australian Made and Owned and based in Ballarat, where it all began.



Protecting our environment for future generations.

We look for innovative ways to lessen our environmental impact by reducing water usage, waste and utilising renewable energy sources. We recently opened our state-of-the-art manufacturing facilities that will allow us to continue this commitment.

In addition, we are proud to:

- + have achieved GreenTag - GreenRate Level A and HealthRate Platinum certification on several of our products
- + be a founding member of Paintback®
- + be a member of Green Building Council



Green Building Council Australia
Member 2023-2024

Low Volatile Organic Compounds (VOC)

Haymes Paint's products are of the highest quality, with a wide selection of very low and low VOC paints that comply with the Australian Paint Approval Scheme (APAS) and Green Building Council (GBC) requirements.

In addition, all Haymes Paint colourants in our colour range contain less than 1% VOC.



Industry Solutions

Maintenance Expertise

At Haymes Paint we focus on delivering a wide range of quality products that will meet the needs of large communal spaces, protect buildings from environmental factors and ensure the maintenance is long-lasting.

We provide support including:

- + Tailored solutions suitable for the maintenance and repaint sector.
- + High-quality, enduring products with very low VOC formulations.
- + Products with no lingering odours, anti-bacterial properties, and long-lasting, hard-wearing finishes.
- + Coatings developed in a state-of-the-art lab (ISO9001 and NATA accredited, APAS certified, and compliant with ISO17025) and manufacturing facility.

Your Colour Professionals

Colour selection can significantly enhance a building's overall visual appeal. Well-selected colours can transform a space into an inviting and vibrant environment, creating a positive impression on residents, visitors, and tenants. Our tailored colour solutions include:

- + Use of colour psychology to influence positive outcomes.
- + Development of tailored colour palettes to aid with wayfinding and orientation.
- + Accurate colour matching, including international colour palettes and Australian Heritage colours.
- + Implementation of Australian luminance contrast principles to support individuals with low vision or vision impairments.
- + Market-leading tinters with colours that remain cleaner and brighter, even under the harshest UV exposure.



Tailored Project Support

Whatever the requirements, we can help you enhance your repaint project for the better through expert support tailored to your needs.

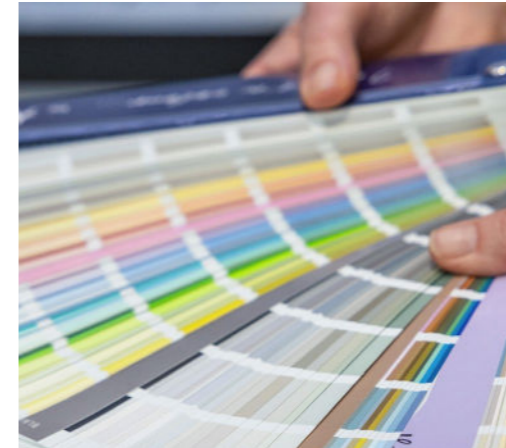

Design and Specification

From colour advice to product specification, our support covers:

- + Colour matching and consultation services for existing and new projects, including heritage colours.
- + A full range of versatile products suitable for the diverse requirements of this sector.
- + Over 50,000 colours to choose from with fast and efficient colour matching.



Project Support

Throughout all project stages, we are here to help. We offer the following support:

- + A dedicated Haymes Paint Commercial Manager assigned to your project.
- + An expert sales team available for project support.
- + Free product delivery to site.
- + A project tracking system, featuring product usage and colour tracking and digital project management tools for supervisors.
- + Tools and systems in place for specification compliance training.



Maintenance and Aftercare

Our support continues well past the handover stage, with specifications backed by Haymes Paint's product guarantee and warranty. We work with you and your clients to customise:

- + Warranties tailored to specific projects, encompassing site and coatings considerations.
- + Specific maintenance guides.
- + On-going product and project support.

Facilities Maintenance & Strata Product Solutions



Ultra Premium Interior

Interior walls, ceilings and trims

Our high-performance Ultra Premium interior ranges are designed to withstand heavy traffic and help protect your assets. Designed with superior stain resistance, washability and durability, they help reduce future maintenance requirements and stand up to continuous cleaning. They have low and very low VOC options to minimise downtime and offer a leading colour space from which to select.



Rendertex Texture Coatings

Interior and exterior walls and substrates

Rendertex Texture Coatings is a full render and texture solution providing long lasting protection without compromising on aesthetic appeal. With high and low build profiles and textural finishes, tintable to the Haymes Paint colour palette, Rendertex provides long lasting durable protection to a wide variety of substrates.



Artisan Collection

Foyers, entrances and high profile areas

Our Artisan Collection of decorative finishes has been meticulously crafted to bring a superior and distinguishing finish to any space. With a carefully curated range of textures and colours, it will elevate your project and bring a fresh point of difference to your facility.



Ultra Premium Solashield®

Exterior walls and facades

Ultra Premium Solashield® is a durable, hardwearing exterior paint with superior dirt and grime resistance to help protect your facility and reduce the need for future maintenance. It provides enduring protection against cracking, peeling, and flaking. It is tintable to the full Haymes Paint colour palette, including the complete heritage colour range that last longer under UV exposure.

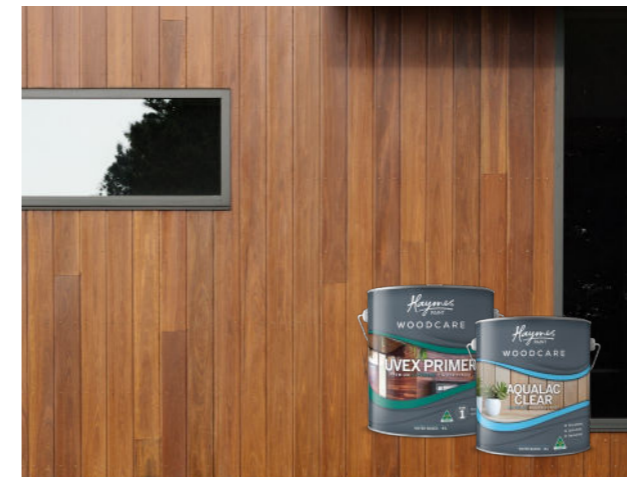

Woodcare Range

Interior and exterior timber

A comprehensive range of stains, oils, varnishes, and coatings for interior and exterior use. Our products enhance timber, protect surfaces in high-traffic areas, shield against UV damage, and can include slip resistance additives for safety and enhanced aesthetics.



Ultimate Protective Coatings

Specialist interior and exterior applications

Our water-based, Ultimate Protective Coatings range provides specialist high performance protection including anti-bacterial, anti graffiti and hardwearing epoxy and polyurethane coatings. With low and very low VOC options, they minimise maintenance downtime.

Facilities Maintenance & Strata Product Solutions



Ultimate Protective Coatings

Flooring, car parks, exposed concrete

The Ultimate Protective coatings ranges for flooring are high performance, durable coatings that will help protect your assets against the daily wear and tear of use. Offering a diverse array of solutions such as durable 2-pack epoxy and polyurethane coatings, this range comes in a variety of colors and has the option to include non-slip additives to enhance safety.

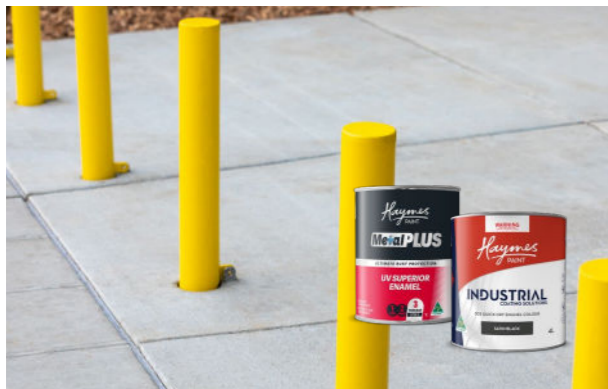

Metal Protection

Interior and exterior metal surfaces

Our MetalPLUS and Industrial Coating Solution encompasses a broad selection of products tailored for high-performance protection of metal substrates. Key features include rapid drying, isocyanate-free formulation, and superior UV protection capabilities.

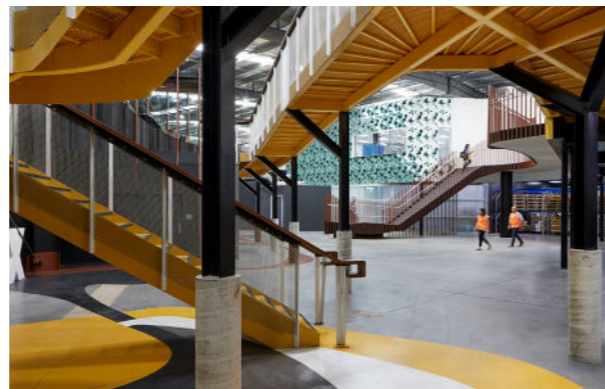

Leading specialty coatings from our partners

Interior and exterior

Haymes Paint partners with leading coating companies to provide the right coating solution for those highly specialised requirements.

Example Facilities Maintenance & Strata Specification

Environment	Challenge	Product Solutions
General Interior Areas	General walls, ceiling, trims	Expressions® Interior Expression® Ceiling Trimplus
	High humidity, 'wet areas', food prep areas	Kitchen & Bathroom Ultimate Anti-Bacterial
	Communal spaces, halls, offices, open spaces	Eggshell
Specialty	Foyers, entrances and high profile areas	Enhance, inspire and create unique finishes for high profile areas Artisan Collection
Exterior	Exterior broadwall	Solashield® Ultimate Anti-Graffiti
	Texture	Rendertex
Metal Protection	General metal	Durable, hardwearing, UV resistance in exterior areas, cover wide range of atmospheric corrosivity categories ICS MetalPlus
Timber Finishes	Interior Timber	Protect and preserve timber, UV resistance in exterior areas, enhance timber finishes Woodcare Aqualac Floor, Woodcare Aqualac Clear + Anti-slip additive
	Exterior Timber	Woodcare UVEX Primer, Woodcare UVEX Finish

This table serves as a general representation. Each project will be tailored to accommodate individual requirements.

CASE STUDY



Glen Waverley Anglican Church

Haymes Paint teams up with Higgins Coatings on a comprehensive restoration of a community church, enhancing both exterior and interior, using high-performance paints to ensure durability and a welcoming atmosphere.



**Read Full
Case Study**

Explore our industry expertise and resources at:
haymespaint.com.au/industry-solutions

GET IN TOUCH

 1800 033 431

 strata@haymespaint.com.au

 haymespaint.com.au

V1 May 2024



Australia's first family of paint.



SINCE 1935